



CHARLES HART, 35 VESSEY ST., N. Y.      COLLEGE POINT      FROEDING      JAMAICA BAY      MANHATTAN BRIDGE      MANHATTAN BEACH      ROOSEVELT ISLAND      STATUE OF LIBERTY  
HARTEN RIVER      KUNDEL'S ISLAND      LONG ISLAND CITY      MADISON SQUARE      NAVY YARD      N. Y. & BROOKLYN BRIDGE      PROSPECT PARK      CONEY ISLAND      RENOY HOOK      HIGHLANDS OF KINGSBURGH  
MORNINGSIDE PARK      CENTRAL PARK      BLACKWELL HEAD BRIDGE      PARK ROW BUILDING      GREENWOOD CEMETERY      FORT HAMILTON      NARROWS      QUANTICO      DEWEE'S ISLAND  
GEN. GRANT'S TOMB      RIVERSIDE PARK      PATENT OFFICE BUILDING      FORT WADSWORTH      STATE OF LIBERTY

**BOROUGH OF BRONX.**      **BOROUGH OF QUEENS.**      **BOROUGH OF MANHATTAN.**      **BOROUGH OF BROOKLYN.**      **BOROUGH OF RICHMOND.**

**THE CITY OF GREATER NEW YORK**

PUBLISHED BY JOSEPH KOEHLER, 120 PARK ROW, N. Y.

Bird's Eye View of the City of Greater New York 1905 Charles Hart Library of Congress www.old-maps.com original size 27" x 39"









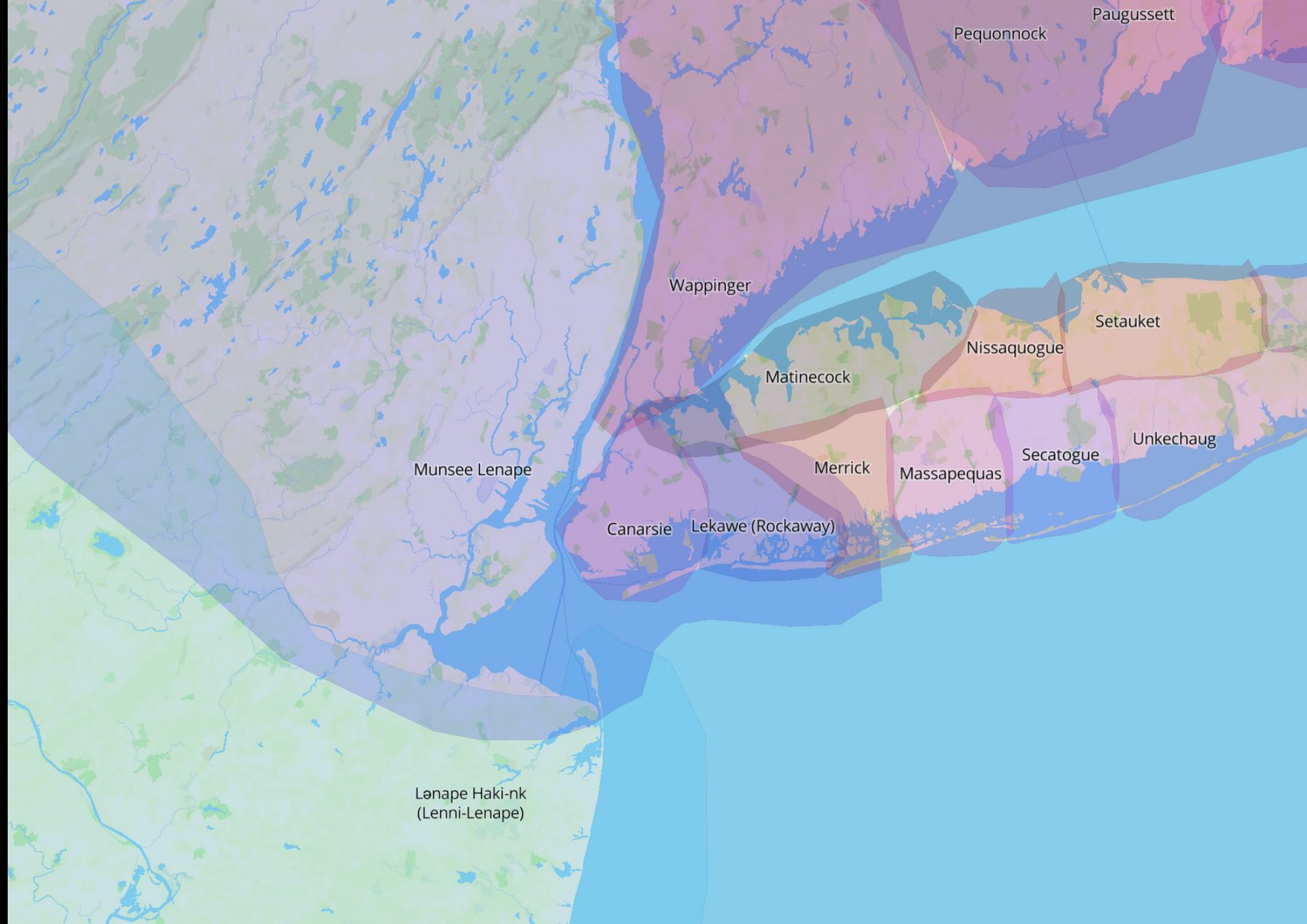

















F. d. N. J. d. d. d.

Manatans

Houck

Hoogh Steenick land

Tapanus

Lalyh landt

Wykagyeck



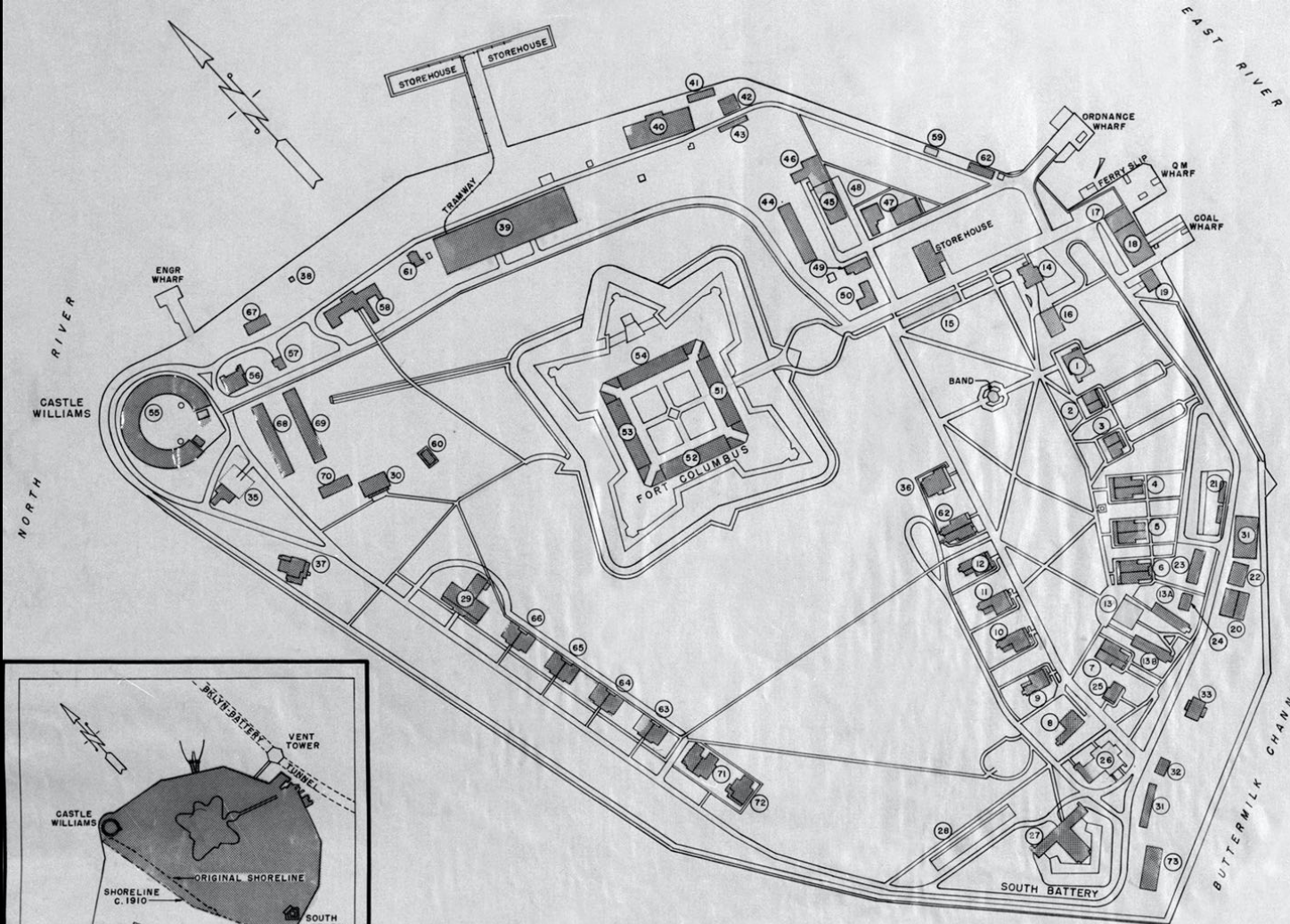

**LEGEND**

- 1 COMMANDING GENERAL'S QUARTERS
- 2 - 12 OFFICERS' QUARTERS
- 13 H.Q. DEPOT
- 13-A SCHOOL
- 13-B PRINTING OFFICE
- 14 GUARD HOUSE & POST HEADQUARTERS
- 15 OFFICES CHIEF QM, INSP GEN'L, MPO DIR & MILITARY SERVICE INSTITUTE
- 16 ACS & QM STOREHOUSE
- 17 POST TRADER'S
- 18 COAL SHED
- 19 STABLES
- 20 Q M STABLE & SHED
- 21 QM STOREHOUSE
- 22 OFFICE POST QM & STOREHOUSE
- 23 CARPENTER & PAINT SHOP
- 24 BLACKSMITH & PLUMBER SHOP
- 25 NCS QUARTERS
- 26 ST. CORNELIUS CHAPEL
- 27 P. X. & GYMNASIUM
- 28 EMP & ENL MEN'S QUARTERS
- 29 BOQ
- 30 YMCA
- 31 CONSERVATORY
- 32 NCO QUARTERS
- 33 SIGNAL STOREHOUSE
- 34 QM STOREHOUSE
- 35 OREMATORY
- 36 DEPT COMMANDER
- 37 F.O.
- 38 STORM SIGNAL TOWER
- 39-40 STOREHOUSES
- 41 PAINT SHOP
- 42 STABLE
- 43 GARDENER
- 44-45 STOREHOUSES
- 46-50 OFFICERS' QUARTERS
- 51, 52 BARRACKS
- 52 BARRACKS, BAND & BAKERY
- 54 BARRACKS & POST SCHOOL
- 55 CASTLE WILLIAMS
- 56 ORD SGTS QUARTERS
- 57 COM'Y SGTS QUARTERS
- 58 POST HOSPITAL
- 59 FIRE ENGINE HOUSE
- 60 MAGAZINE
- 61 M S QUARTERS
- 62 CARPENTER SHOP
- 63-66 OFFICERS' QUARTERS
- 67 BAKERY
- 68-69 PAVILION HOSPITAL
- 70 HOSPITAL MESS
- 71 CAPT'S QUARTERS
- 72 FIELD OFF.
- 73 COMPOST HEAP

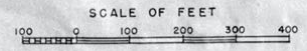
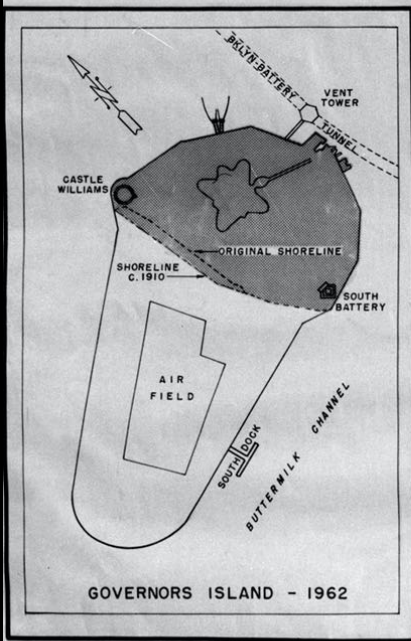

PHOTOGRAPHED OCT. 10, 1903 - APRIL 22, 1910  
 CORRECTED APRIL 16, 24; MAY 23; JUNE 21, (ALL 1906);  
 MAY 31, 1907; MARCH 13, 1908.

**FIRST U S ARMY ENGINEERS  
 MAP OF  
 GOVERNORS ISLAND - 1908**

FROM A DRAWING BY J. M. HILTON

REDRAFT  
OF  
THE CASTELLOPLAN  
IN  
1660

JOHN WILHELMUS DE WILHELMIS  
1671-1672







A PLAN of NEW YORK ISLAND, part of LONG ISLANDS: showing the Position of the AMERICAN and BRITISH Armies, before, at, and after the Engagement on the HEIGHTS, August 27<sup>th</sup> 1776.



Drawn by A. Leitch.

Printed and Published by C. F. Johnson.

J.B. Spence del.



No. 46292  
Green Newtown.  
Ohio Exp. Station.  
Wooster, Ohio.

R. G. Steadman  
4-2-18  
11-23-17



NORTH RIVER

NEW YORK ISLAND

EAST OR SOUND RIVER

A PLAN of  
the CITY and ENVIRONS of  
NEW YORK  
in  
NORTH AMERICA.

Scale  
0 100 200 300 400 500 600 700 800 900 1000 f

PART OF  
LONG ISLAND

PART OF  
LONG ISLAND







24773  
Peach  
E. Nave  
Tampa, Hillsboro Co. Fla.

G. G. Pastorek  
6-2-1902



GREEN GAGE PLUM.





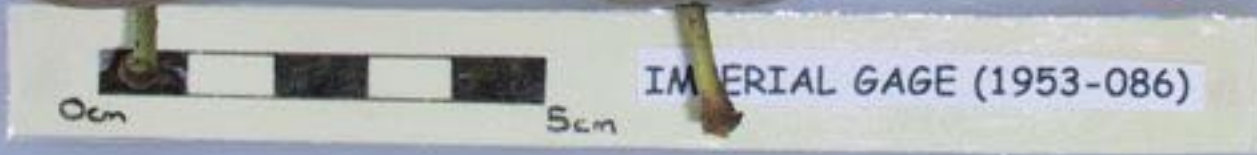

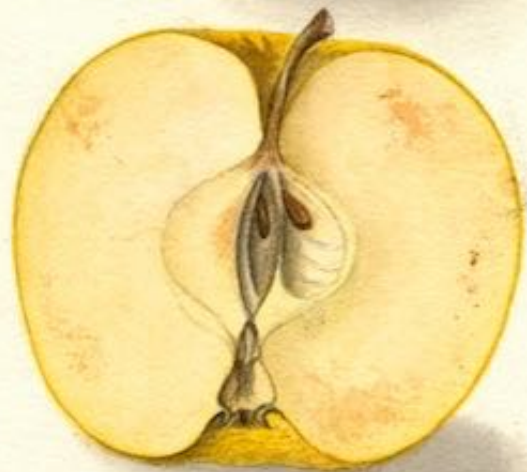

No. 357114

'Fall Pippin'  
L. S. Jennings (Grown by Poppleberry)  
Harrisonville, Santa Cruz Co., Cal.

E. J. Schmitt.  
Oct. 16-1908.



52764

'Fall Pippin'  
Maine Sanatorium  
Webster, Me.

J. J. Newton.  
10-16-11  
12-2-11



16075  
Lickman  
from E. Harley & Sons  
Hart & Co. Mich.

J. L. Roseman  
Jan Aug 16. 75



64039

Lemon Cling (4196)  
Arlington Farm  
Parsly, Va

M. D. Arnold  
8-21-13  
8-30-13

62.61

CATALOGUE

OF

FOREST TREES, FLOWERING SHRUBS  
AND EVERGREENS.

*Herbaceous Plants, Bulbous Roots*

AND

FRUIT TREES,

ALSO,

GARDEN AND FLOWER SEEDS,

FOR SALE

BY MICHAEL FLOY,

NURSERY AND SEEDSMAN,

UPPER END OF BROADWAY,

NEW-YORK.

NEW-YORK.

PRINTED BY PELSUE AND YOUNG,

No. 86 Nassau-street.

1816.

1816



GEORGE IV





#108090

Bloodgood

D. J. Shoemaker

Vicksburg, Miss.  
near Camden, Miss.

Henry D. Knicker

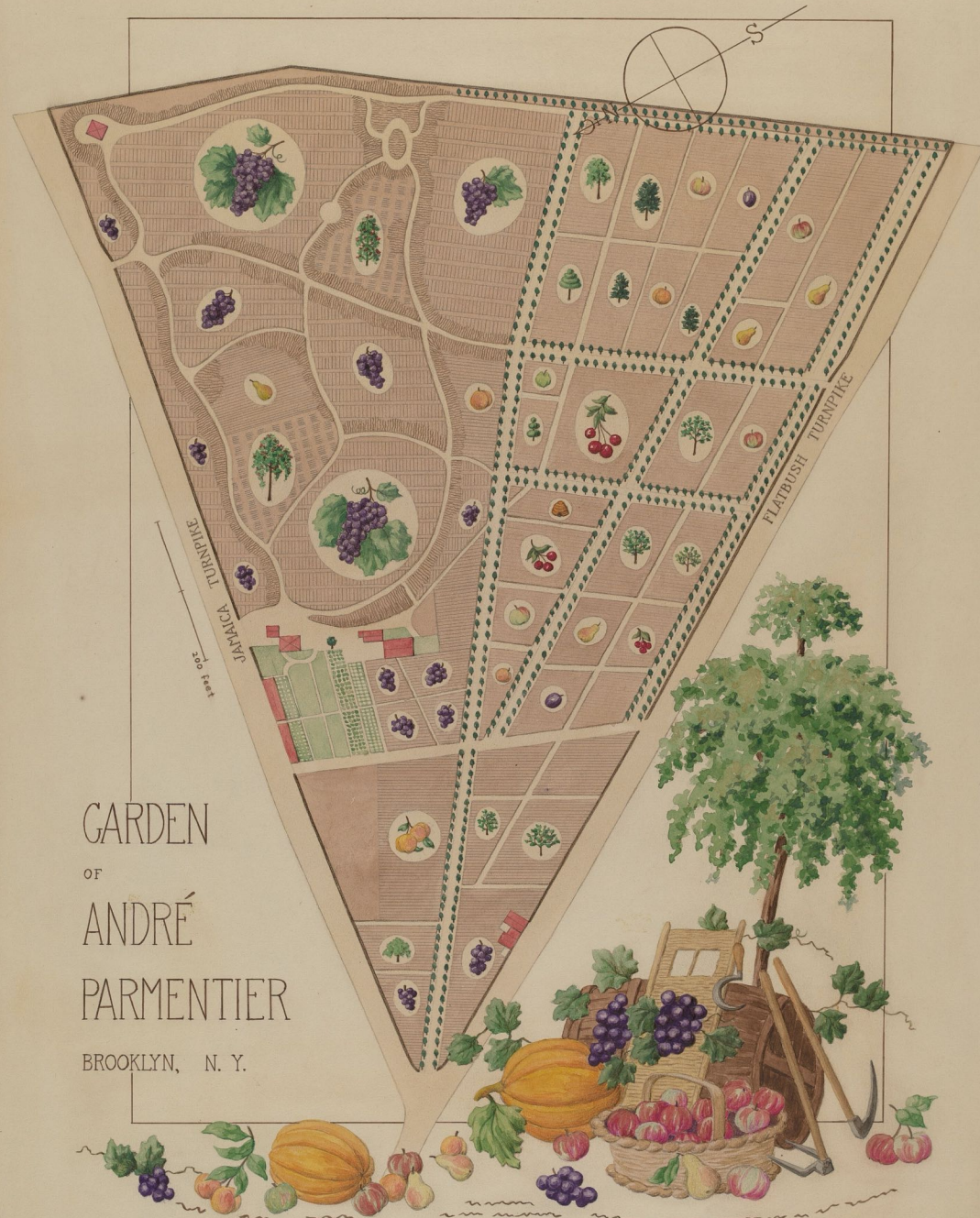

GARDEN  
OF  
ANDRÉ  
PARMENTIER  
BROOKLYN, N. Y.



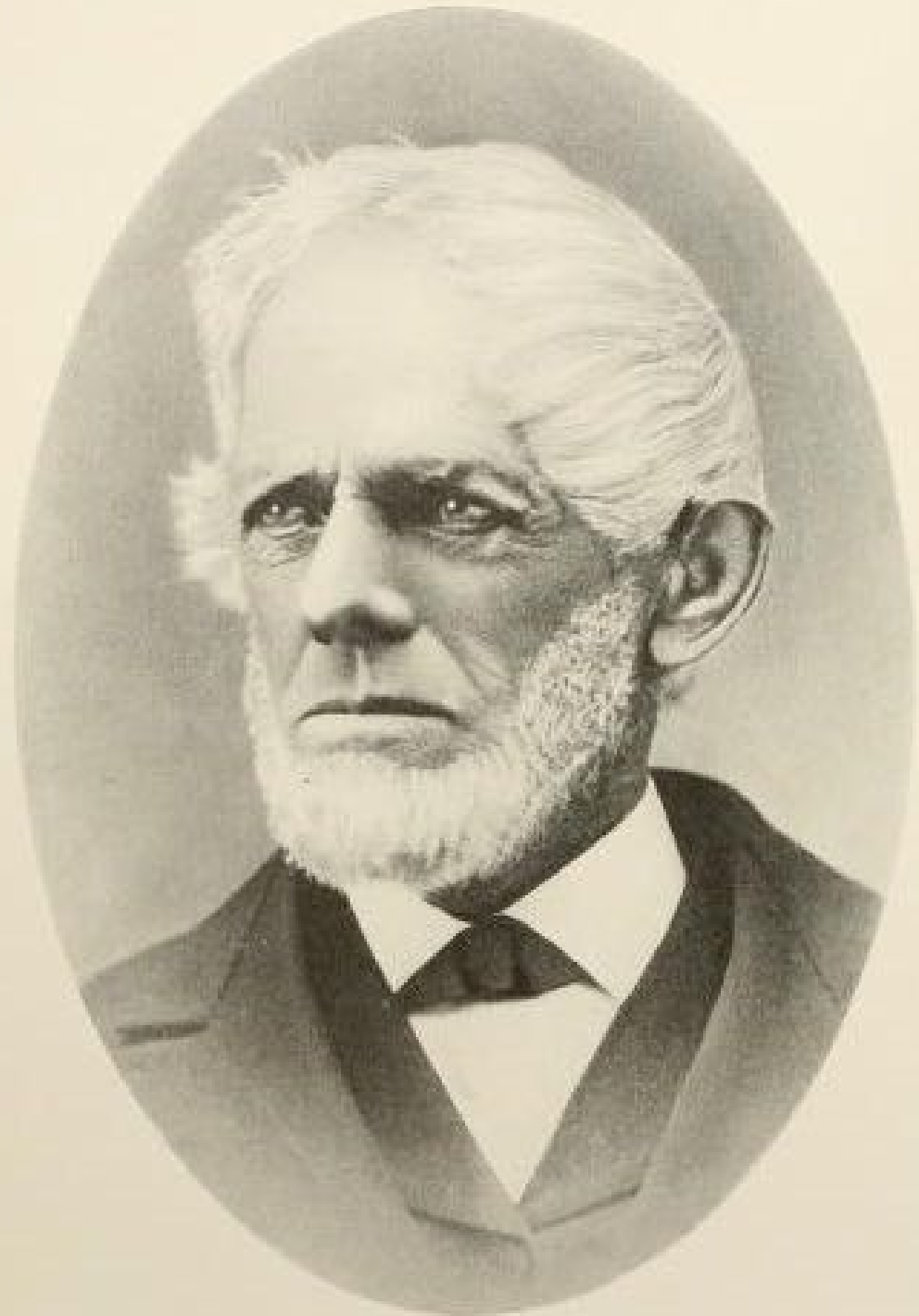

Your sincerely  
A. S. Downing



59

77

86

94

97

103

106

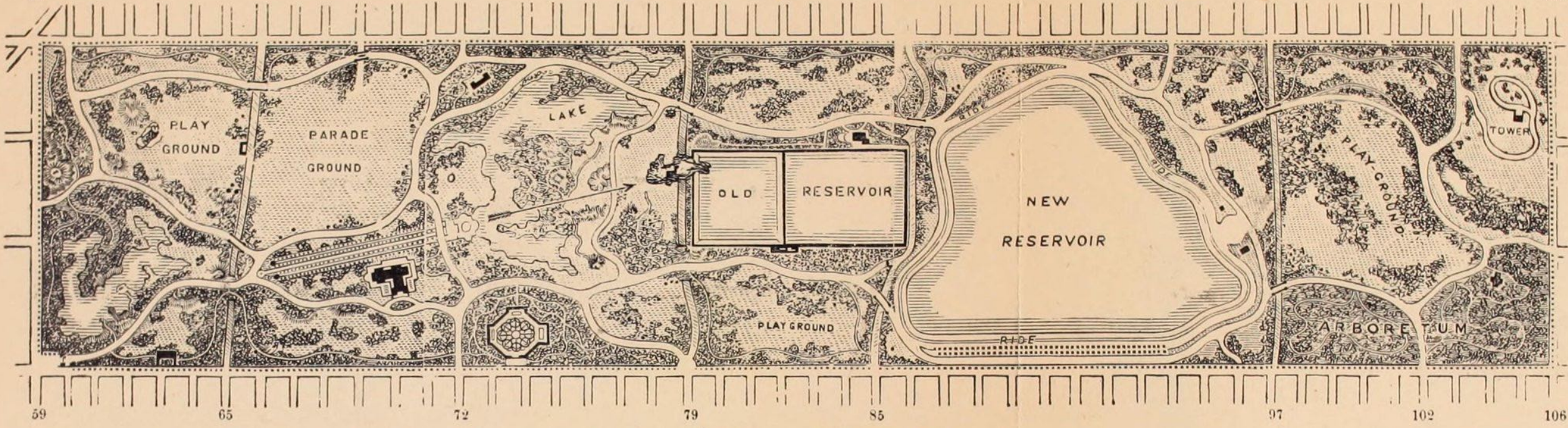

59

65

72

79

85

97

102

106



35582  
Le honte  
Rome 7.  
Lot. A. maffei  
11/19/01

A. C. B. G. G.  
11/20/01



17643

"6" Strawberry  
from H. L. Adams  
Benton Harford Co. Md.

J. L. Passmore

Early Strawberry



57460  
"Gloria Mundi"  
L. C. Hays  
Midway Tenn.

J. J. Newton  
8-12-12  
8-16-12



20701  
H. W. Saunders  
Hawley  
Success Co. N. Y.

W. C. Rasmussen  
N. Y. 1900

*Greenish-yellow*



# 7267 Red 9/1/94

J. B. Rasmussen

Hawley from Allan Crawford  
Springport, Yates Co. N. Y.

"Hawley" - syn. "Russet"

9-1-94

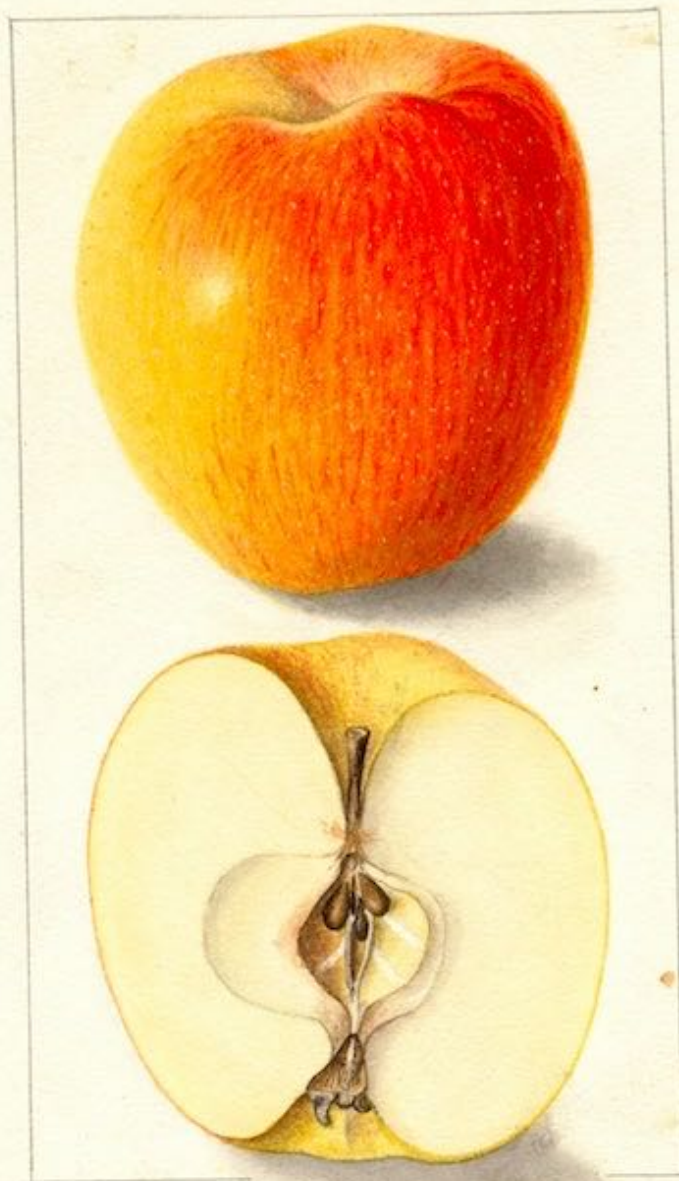

No. 32771  
"Newtown Spitzenburg"  
C. H. Edwards.  
Butler, Silver Row exp. mount.

E. J. Schmitt  
Oct 28 1894



STREAKED PIPPIN



#5602

"Hutfield"  
Clay Co.  
S. Dak

J. H. Passmore

E. D. Bowles,  
Vermillion,  
Clay Co. Dak.

10-10-93





• The Apples of New York (1910)

## The Fruits of New York

New York Horticultural and Agricultural Experiment Station  
 Department of the New York State Agricultural Experiment Station

From 1885 to 1910, the New York State Agricultural Experiment Station (NYSAES) published a series of botanical monographs on fruits from all continents of the New World. The publications began with the New World Fruits of New York in 1885, and continued with the following titles: Horticultural Garden America (1885-1890), World Horticultural Garden of Fruit (1891-1895), The Fruit Garden of the World (1896-1900), The Garden of the World (1901-1905), and the Garden of the World (1906-1910). The series of monographs on the fruits of New York was the first in the world to be published in a series of volumes.

Volume 1 (1885) was the first in the series, and it was the only one to be published in a series of volumes. It was the only one to be published in a series of volumes.

The goal of each volume was to provide a complete botanical, cultural and economic history of each fruit. The series of monographs on the fruits of New York was the first in the world to be published in a series of volumes.

• The Fruits of New York (1885)



• The Grapes of New York (1910)

- The Apples of New York (1910)
- The Grapes of New York (1910)
- The Fruits of New York (1885)
- The Cherries of New York (1910)
- The Peaches of New York (1910)
- The Plums of New York (1910)
- The Small Fruits of New York (1910)

• The Cherries of New York (1910)

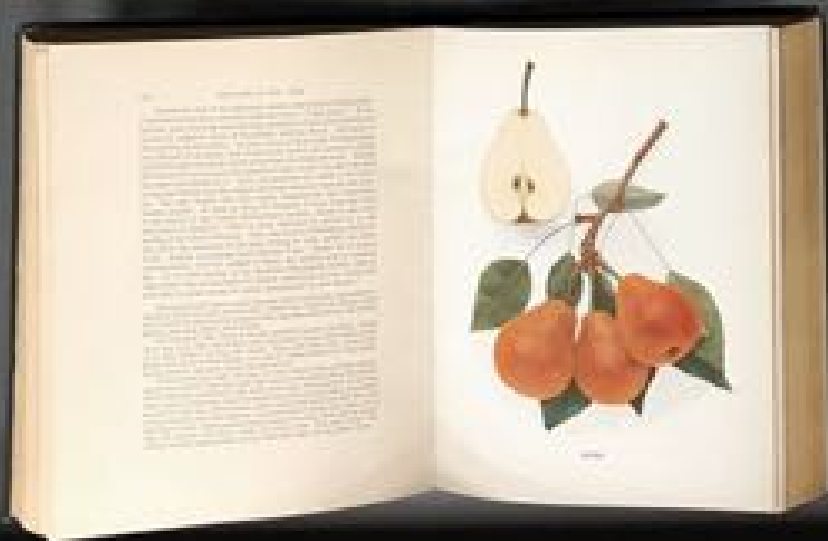







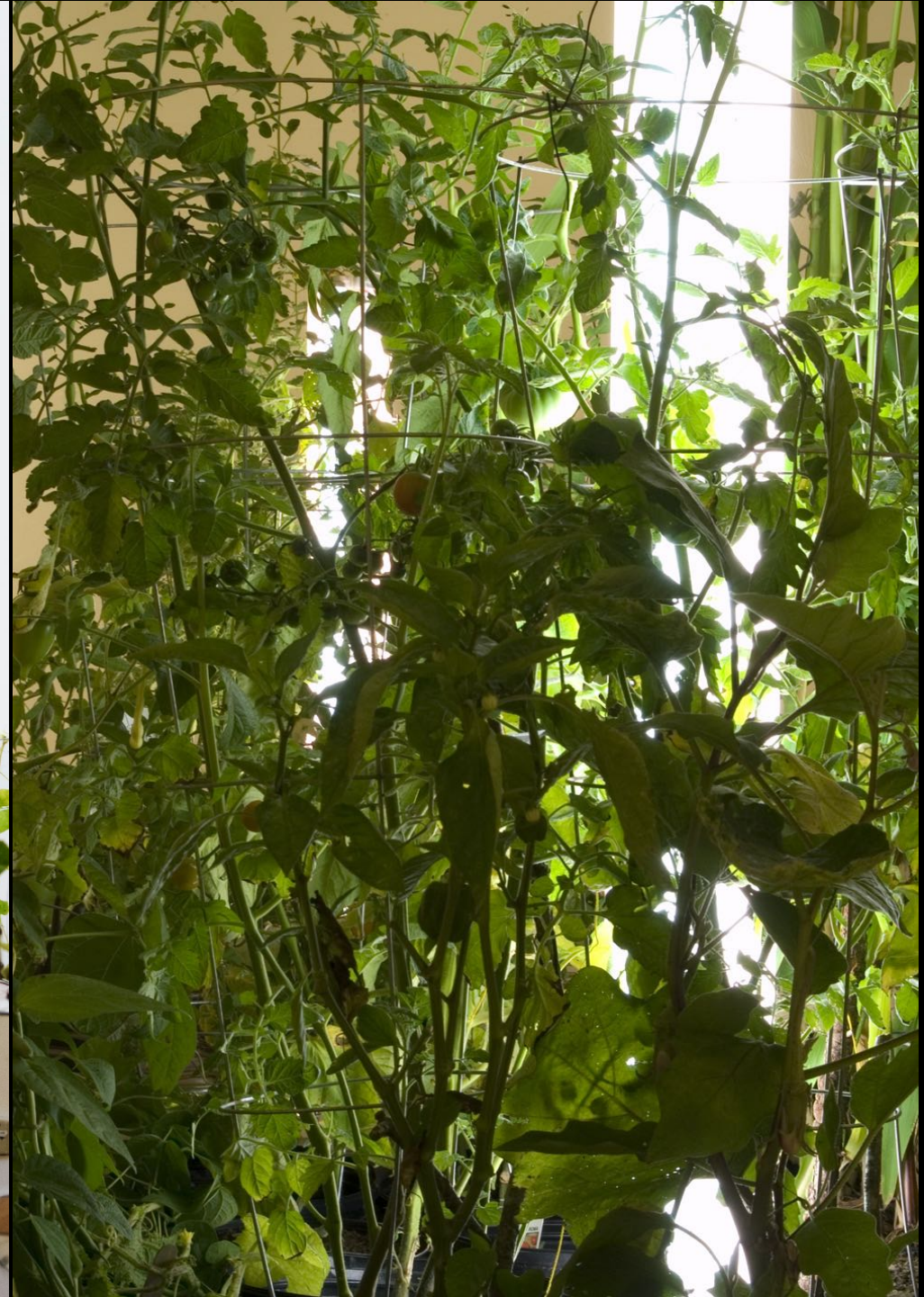

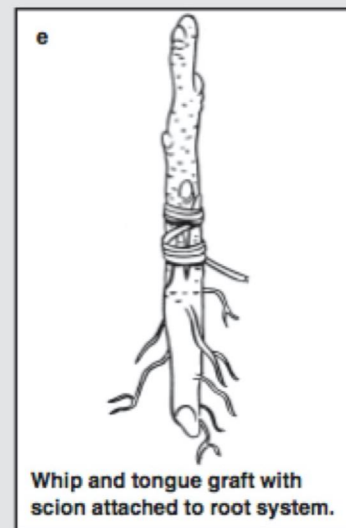
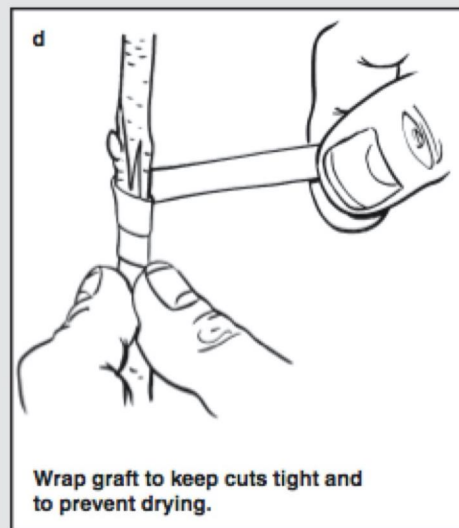
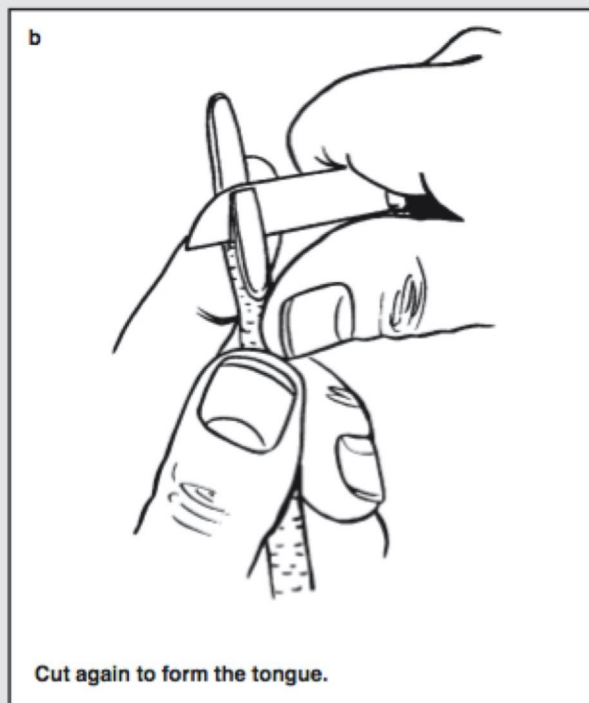
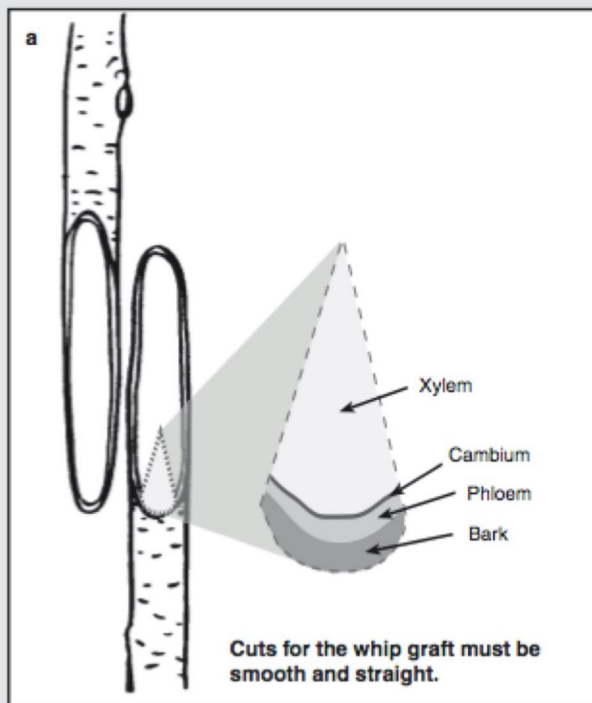

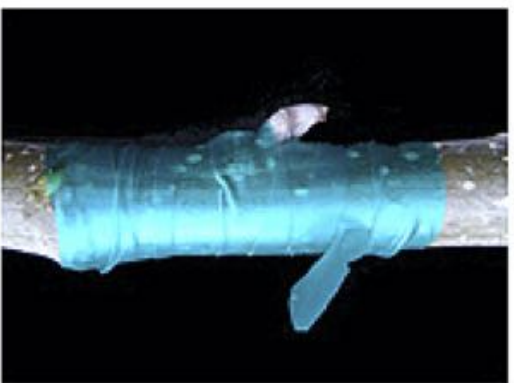





Figure 1. Whip Graft





















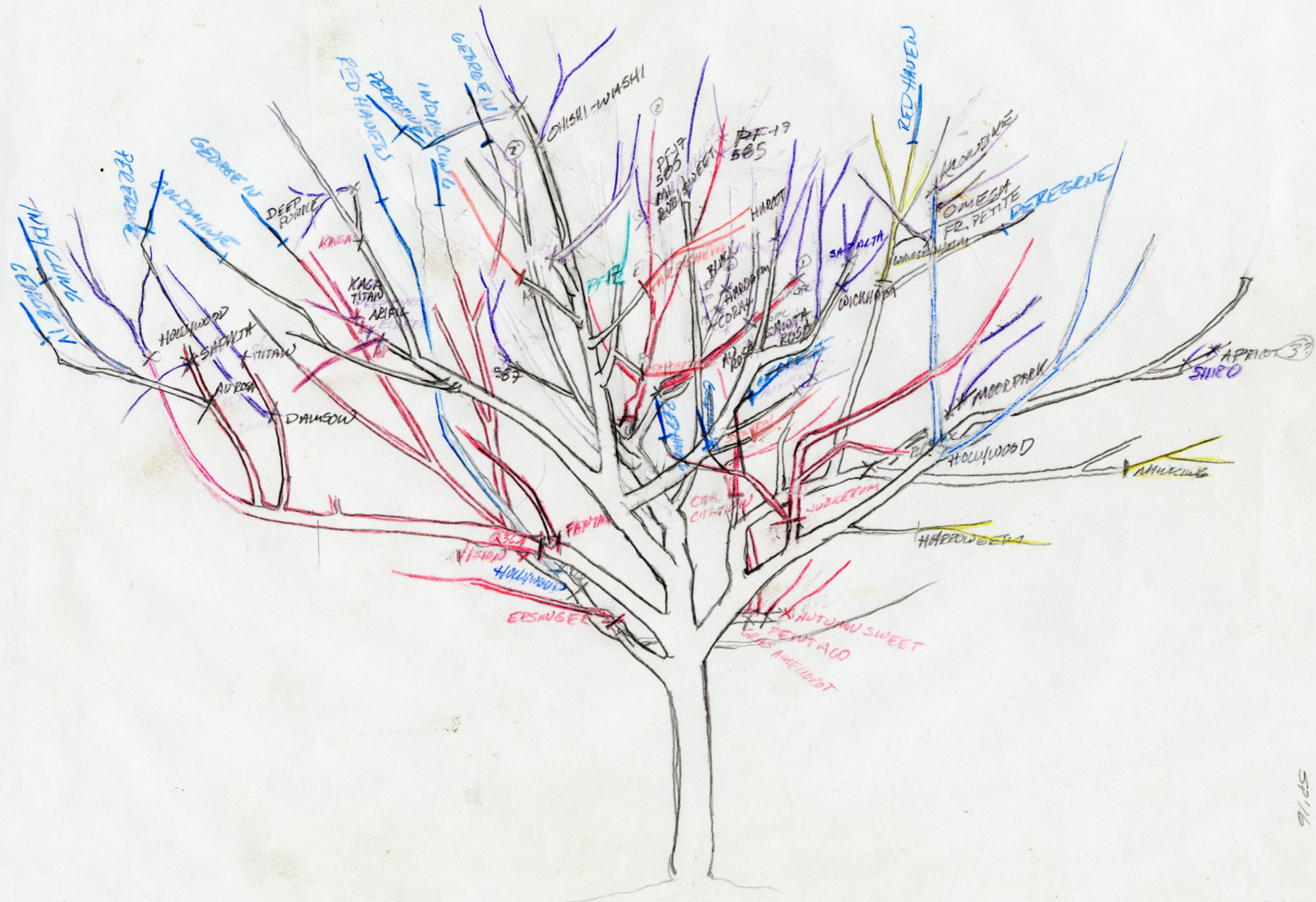











# Sited Trees

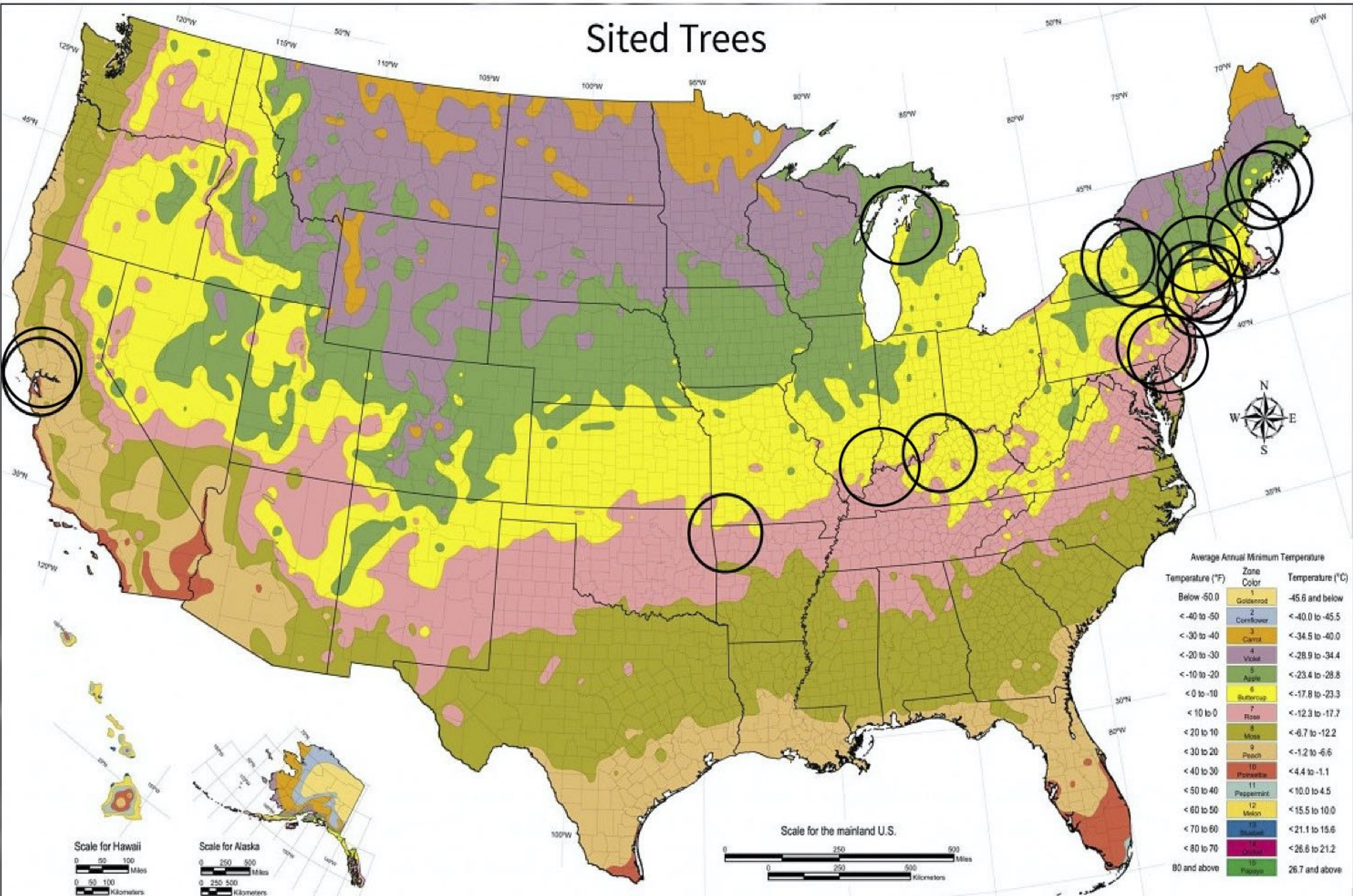













1 2 3 4 5 6 7 8 9 10 11 12 13 14 15 16 17 18 19 20 21 22 23 24 25 26 27 28



THE OPEN ORCHARD PROJECT  
ROSACEA  
*Prunus persica* GEORGE IV  
Locality: United States, New York, Otsego County  
43°28' N 76°54' W  
Coll. AUGUST 21 2018 (MML) ZUR  
Hab. ORCHARD - NY STATE  
Freq. RARE  
Original: BRAND ST. NEW YORK NY 1821  
Notes:















## How Do You Design a Tree?

Join the start of the #treeof40fruit journey.  
Share your photos daily.

## Tree of 40 Fruit, 2008–ongoing

Participate!  
Come try your hand at grafting.













**George IV**  
*Large Early York var.*

*George IV*  
*Large Early York var.*

1. Downing, Jr. *Fruit and Veg. Cult.*, Am. Ed. 1824, p. 104; 2. Elliot & P. Red. 174, 1824; 3. Watson, *Sci. P.*, 179, 1830; 4. Watsch, *Sci. P.*, 202, 1833.

One of the first named American peaches, George IV, is said to be among the three best white-fleshed peaches and was once a favorite of American peach-growers. In the 1820's it was the more popular peach for garden culture. Discovered as a chance seedling in the garden of a Mr. Gill, Broad Street, New York, in 1821, near Trinity Church is what is called the Financier District, the variety rapidly grew in favor and within a few years was grown everywhere in the United States and was taken to Europe where it became a standard peach. At the turn of the nineteenth century, it was still widely grown there although it had fallen out of favor in the U.S. in the 1870's, local for choice, a process undoubtedly the shipping.

Its parentage is uncertain which has led it to be confused with other sorts. Downing suggested it was said to be synonymous with Large Early York. Additionally, it was often confused with Moore Red, an old Red Haverpe brought to the United States by Maguerre emigrants, of which it was thought to be the best of the original variety.

Tree large, vigorous, upright, spreading, somewhat bushy, regular, moderate crop, thick trunk. Leaves are 7" long x 1 1/2" wide, tapering upward and recurved, mid to above-lanceolate, thick, leathery, upper surface dark green, smooth except near the middle, lower surface gray-green, calyptra gland smooth, at the base of blade.

Flower small, bush short, obtuse, plump, heavily pubescent, appressed, blossoms mid-season, flowers pale pink, center and edges with darker pink. Blossoms 1 1/2" across, petals roundish-oval, opening to close not at the base, therefore 1/2" long, equal to petals in length, petal longer than stamen.

Fruit, mid-season, late of August, 2 1/2" long x 2 1/2" wide, roundish-oval, helped of near apex, calyx, cavity slightly contracted, deep, sharp, rather shallow, becoming deeper and open and convex. Apex round with mucronate tip, thin, slender. Color green-white changing to cream-white, pink bluish, later mottling of red. Pit, which, depth tinged red near pit, jaws, slender, ash, narrow base.

Stone semi-free to free 1 1/2" long, 1/2" thick, round, oval, plump, flattened at base opening to short point, grooved surface.



#### Common Damson

Damson	Blue Damson	Purple Damson
Black Damascene	Small Round Damson	Early Damson
Damas	Damascus	Kriochie

1. Downing, *Fr. Trees Am.* 377-378. 1857. 2. Cole, *Am. Fr. Book* 217. 1858. 3. Elliot *Fr. Book* 426. 1858. 4. Hedrick, *Plants of New York* 185-186. 1911.

Considered the ancestor of all plums, the Common Damson is estimated to be well over 2,000 years old, the plum eaten and spread by the Romans. Taking its name from Damascus, it was brought to Italy at least a century before the Christian Era. Renowned for its distinctive spicy and tart taste, it is prized for preserves and was once popular in the markets of the early colonies. It is nearly impossible to find today.

A specific variety, the Damson is also the common name for a group of plums, *Prunus Inuitita*. Historically grown from seed, the Common, or Blue Damson, is the parent of numerous sub-varieties, including Winter Damson, Prune or Shropshire Damson, Sweet Damson, and St-Julian. Unsurpassed in vigor, hardiness, adaptability to varying soil and climate conditions, it is the hardiest of plums.

Tree of medium size and vigor, upright, spreading, vaseform, hardy, enormously productive; branches dark sage-gray, thorny. Leaves folded upward oval, 2 1/4" long, 1 1/4" wide, upper surface dark green, lower surface silver-green, pubescent; petiole 5/8" long, one to two small glands or glandsless.

Flowers late, medium length, appearing before leaves, 7/8" across, buds cream colored changing to white, borne in clusters on lateral buds spurs, typically in pairs; anther reddish, filament 5/16" long, pistil shorter than stamen.

Fruit late; small, 1" long, 7/8" diameter; round-oval, cavity shallow, narrow; skin purple covered by light blue bloom; flesh amber-green, distinct, rich, melting, juicy, spicy, tart, acidic, slightly astringent; stone free, tinged red, 5/8" by 1/2" in size, ventral and dorsal suture broad, shallow groove.





### Napoleon

Royal Ann	Napoleon Bigarreau	Ox Heart
Bigarreau Laueremann	Laueremannkirsche	Clarke's Bigarreau
Harrison's Heart	Wellington	

1. Kedrick, New Am. Oak. 273-274. 1883. 2. Downing, Fr. Treas. 249-250. 1857.
3. Elliot, Elliot's Fruit Book. 212. 1858. 4. Cole, Am. Fr. Book. 234. 1858.
5. Wickson, Cal. Fruits. 186. 1909. 6. Taylor, Ch. of New York. 200-201. 1914.
7. Hedrick, Cycl. Of Hardy Fr. 149. 1922.

Napoleon is of unknown origin. As early as the turn of the eighteenth century, it was grown in Germany, France, Holland, and England; proof that it is a very old variety. Described as early as 1667, it has been in the United States since at least 1820. Beautiful in appearance, it is a magnificent desert cherry, preferred over all other sweet cherries for culinary purposes. Ships well and keeps longer than most.

Tree of upright growth, sturdy limbs, open-topped, free growing, productive, enormous bearing; trunk thick, shaggy; branches thick, dull brown overlaid with ash-gray, comes into bearing early; fastidious to soil; buds variable in size, conical, arranged singly or in thin clusters from lateral buds and from spurs.

Flowers midseason; white 1 1/8" across, in scattering clusters of ones and twos; pedicels varying in length, averaging 1" long.

Leaves 5 1/4" long, 2 1/2" wide, folded upward, elliptical to obovate; upper surface dark green, rugose; lower surface light green; apex acute; base variable shape; petiole 1 1/4" long, thick, tinged dull red; red-orange glands.

Fruit matures midseason, over 1" in diameter, conical to long-cordate, compressed; cavity deep, wide, flaring; suture a distinct line; apex much pointed; color is pale yellow becoming amber in the shade, varying shades of bright red cheek over a yellowish background, distinctly mottled; dots obscure; stem slender, more than one inch long, adherent to the fruit; skin thin, rather adherent; flesh whitish, with a lust yellow tinge, with colorless juice; firm, rich, tender, meaty, crisp, mild, the flavor improving as the season advances, sweet; good to very good in quality.



### Peach

Pêche	Pêche De Nancy	De Nancy G. Dak.
Grosse Pêche	Royal Peach	De Luxembourg
Abriçot. Pêche. N. Dak. Pit	Anson's Imperial.	Wurtemberg
Pfirsiche		

1. Cove, *Vine Cult. Fr. Trans.* 241. 1817. 2. Kedrick, *New Am. Orch.* 251. 252. 1833.  
 3. Downing, *Fr. Trees Am.* 239-240. 1837. 4. Cole, *Am. Fr. Book.* 261. 1838. 5. Fish,  
*Apriçot.* 6. 1880. 6. Wickson, *Cal. Fr. Trees.* 177. 1909. 7. Hedrick, *Cult. Of Hardy Fr.*  
 134. 1922.

Grown for at least four centuries, Pêche de Nancy, or Peach apricot, is one of the oldest, best known and finest apricots. Originally from the Piedmont region in France, where it was raised from seed, it continues to be a standard of excellence in Europe for apricots. Peach is the ancestor of the Royal, Blenheim, and Moorpark varieties. Peach resembles Moorpark but larger, finer, and ripening a few days earlier.

Considered to be the best of all apricots in the early 1800s, later in that century it became a popular favorite in the Sacramento Valley for canning and drying. Although it ripens rapidly and fades in appearance, it is considered the finest apricot in taste and flavor.

Fruit ripens in August before Moorpark; large, 2 3/4" diameter; round-oval, flattened, compressed; well-marked suture, deep at base diminishing toward apex; skin pale yellow lacking pigment on shaded side, and deep orange-red on the side next to the sun; flesh saffron color; very delicate, juicy, melting, sugary, highly flavored with a rich and somewhat musky flavor; finest quality, excellent, delicious; stone large, flat, rugged, and perforated along the back; kernel bitter.





















Open Orchard: Artist Rendering









**GOOD TO KNOW**

- All restroom facilities are ADA accessible.
- Free Wi-Fi is available throughout the island! Just connect to the Governors Island network.



Brooklyn Battery Tunnel wait shaft

Pier 62  
Ryder Dock

Pier 112

**YANKEE PIER** WEEKEND SERVICE  
 Governor's Island Brooklyn Ferry to Pier 6  
 NYC Ferry to Wall St./Pier 11

BROOKLYN

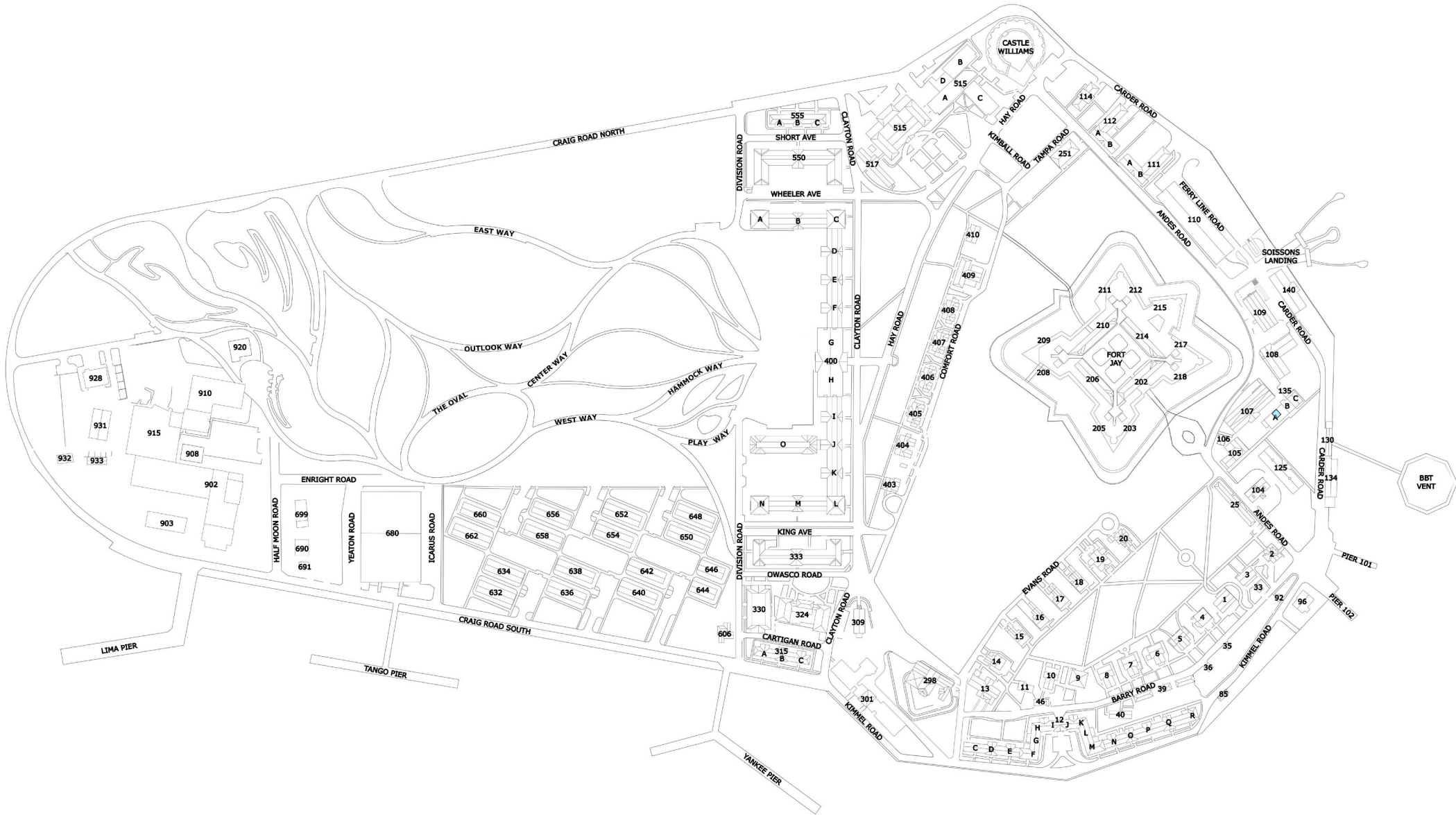



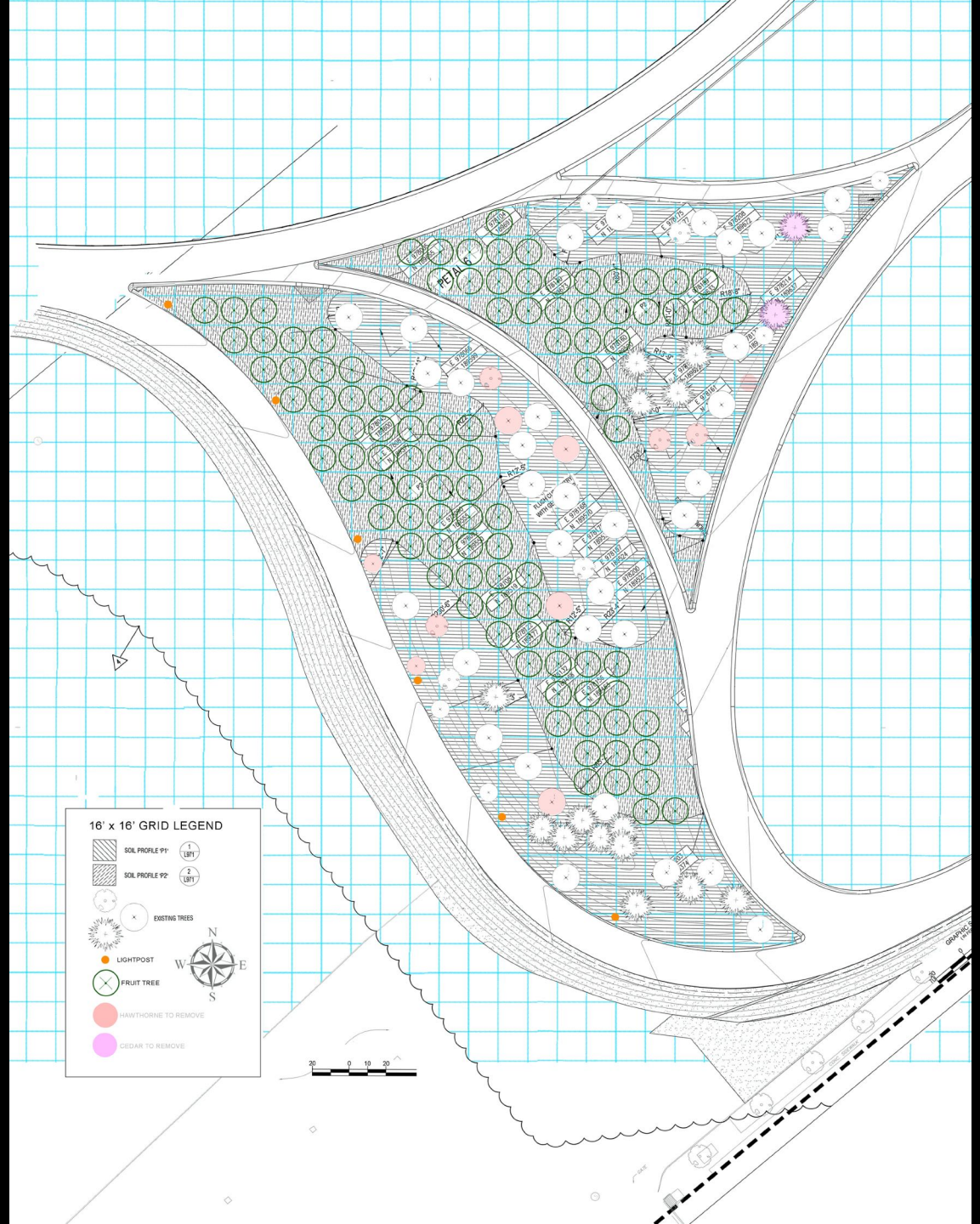

**16' x 16' GRID LEGEND**

	SOIL PROFILE #1		1
	SOIL PROFILE #2		2
	EXISTING TREES		
	FRUIT TREE		
	LIGHTPOST		
	HAWTHORNE TO REMOVE		
	CEDAR TO REMOVE		



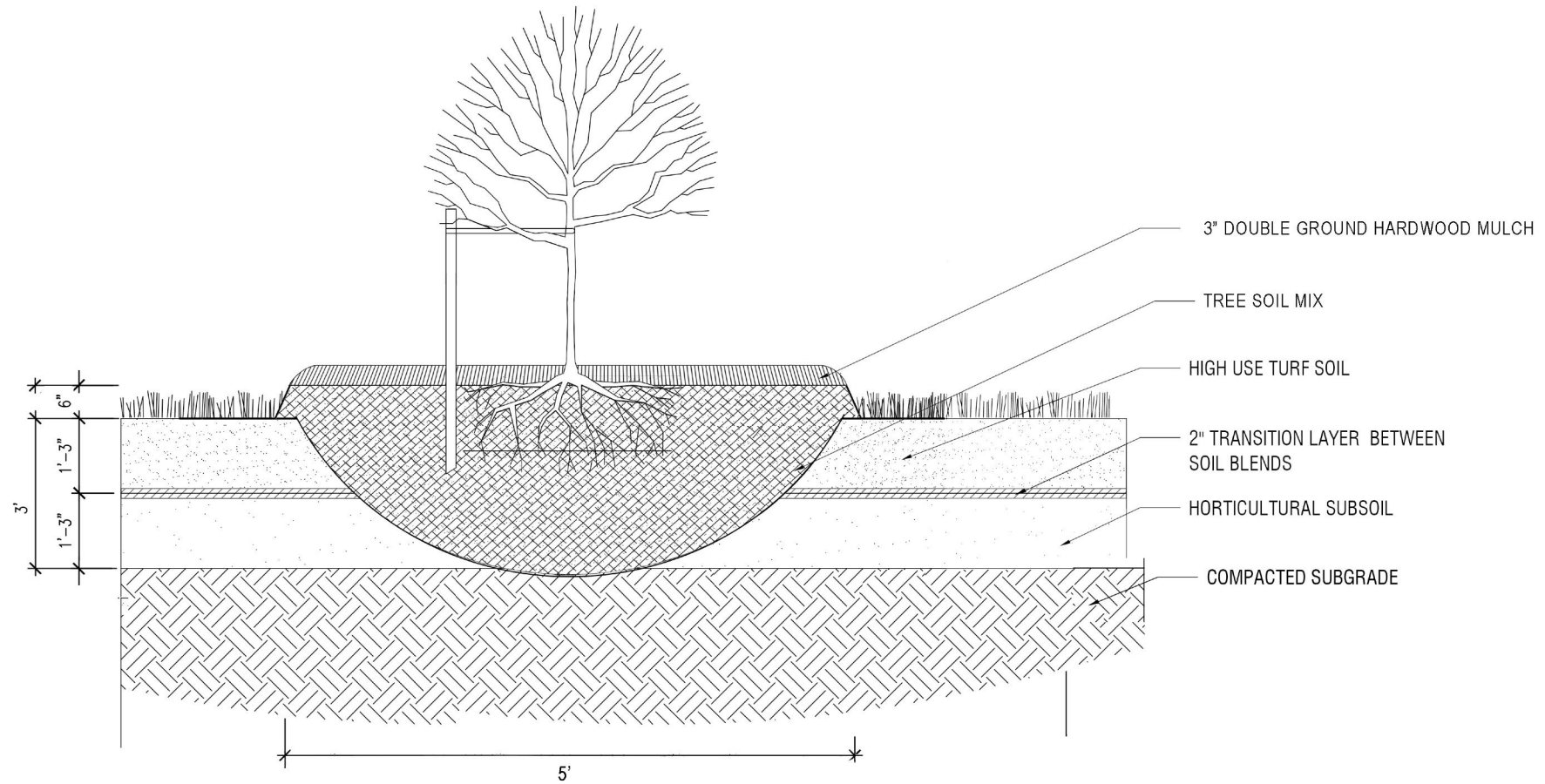

1  
L-971

BAREROOT TREE PLANTED IN TREE SOIL MIX  
SOIL PROFILE 'P1'

1/2" = 1'-0"

















